

Product Data Sheet



CL-C00-100

Sealed CMOS Camera (NTSC)
with 0.5m Cable

Horizontal Lens Angle: 118°
Vertical Lens Angle: 89°



Video signal	Sensor NTSC = 720(H)x480(V) 60fld/s. 1 Vtt composite video into 75 Ohm.
Sensor element	¼" CMOS digital image sensor. 640 H x 480 V.
Light sensitivity	<0,05 Lux.
Dynamic Range	80dB.
Power input	Electrical 12...24V/DC. Below 6V: camera is non functional. Between 7V heating element automatically activated (20% capacity). At 8V the camera is fully functional and the heating is at 40% of its capacity. At 12V the heating is at 100% capacity. Between 12V and 33V camera and heating element are fully functional. Above 33V the overvoltage protection is activated and camera plus heating element are switched off. This overvoltage-protection is deactivated below 32V. Powercircuit is protected up to 80V/Dc. Outputs are Short Circuit Protected. <i>In all these above mentioned values; a tolerance of +/-10% is applied.</i> Heating off: 1.1W at 12V, 1.2W at 24V; Heating on: Max. power at 24V 0.15A = 3.6W Max. power at 12V 0.28A = 3.4W At 12V: 4.5A, 300us. At 24V: 12.0A, 300us.
Power consumption	
Inrush current	
Heater element	2.4W max.
Transient protection	Camera may be powered directly from 12V or 24V battery without additional electrical protection since camera has an integrated circuit that protects the camera against over- and undervoltage, spikes, ripples and loaddumps.
Connectors	0.5m cable with 4p molded male connector (camera power input and video output).
Min. cable bend radius	50mm.
Housing	Mechanical Cycloloy (PC + ABS). Filling: Camera is potted with Polyurethane elastomer.
Ingress protection	IP68 according to IEC 60529; dust tight and protected against the effects of continuous immersion in water up to 10m under water for 30 minutes. IP69k according to DIN 40050-9: camera can withstand a high pressure cleaning with water: 14-16L/min. 80°C and 100 bars flow.
Mounting hardware	Standard stainless steel.
Shock constancy	Shock and vibration resistant for usage on trucks, cranes, fork-lifts, maritime applications, machinery. Random vibration test 15.3Grms at frequency: 24 to 2000, PSD (g ² /Hz) 0.04 to 0.10.
Camera bracket	Material: glass reinforced polyamide, test: 50 Nm at -40°C to +85°C.
Weight	0.21kg, 0.29 in standard packing.
Truck use	Withstand all fluids and materials used in and around trucks like: ammonia solution 5%, ethanol 80-100%, isopropanol 5-10%, soapy water (min. 50% soap per volume), alkaline degreasing compounds(used in high pressure washing equipment).
Operating temperature	-40°C to +85°C.
Storage temperature	-40°C to +100°C.
Approvals	Certification Approvals in compliance with all relevant EMC- and Automotive directives. This device complies with Part 15 of the FCC Rules. Operation is subject to the following conditions: (1) this device may not cause harmful interference, and (2) this device must accept any interference received, including interference that may cause undesired operation. Certificates available upon request.
Green Passport	All materials are compliant to Green Passport requirements according IMO resolution MEPC.197(62) as adopted on 15 July 2011 (Maritime sector: International Maritime Organization concerning the functions of the Marine Environment Protection Committee).



Product Data Sheet

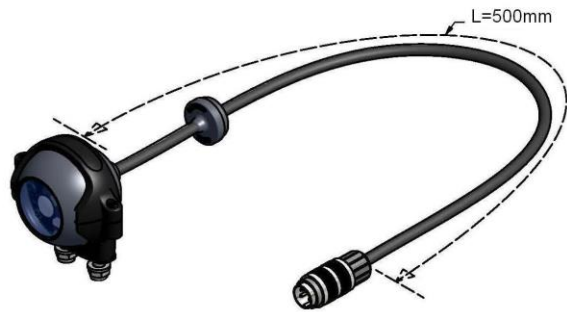
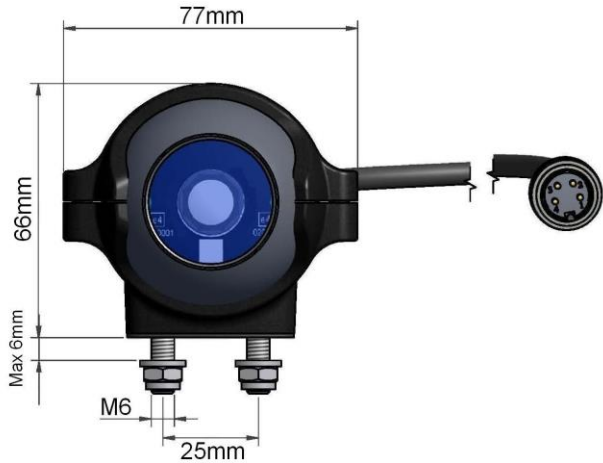
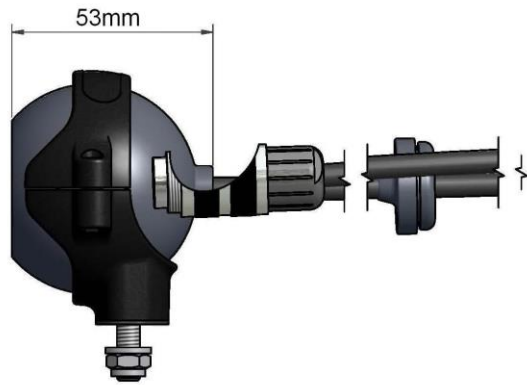

Universal camera Bracket

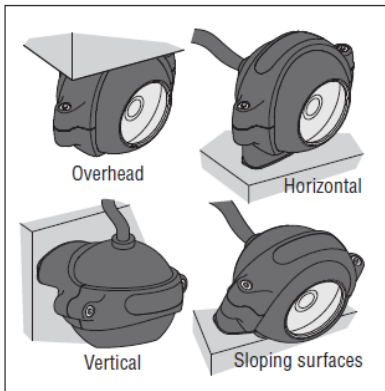

Camera attachment and dimensions

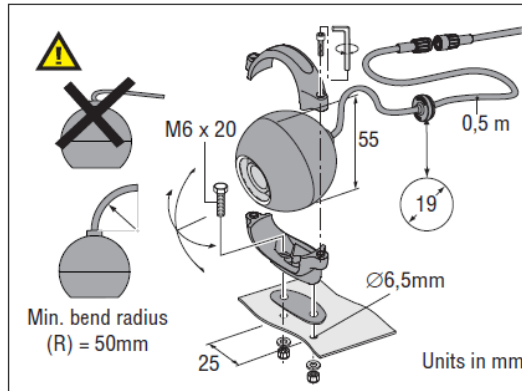

Front side of molded 4p male connector

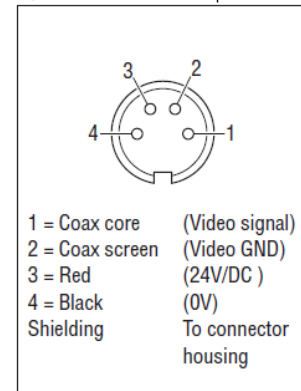

For more information, please contact us at:

email: sales@hedonline.com

Or call us at:

phone: +1.800.398.2224

Information contained on this sheet is accurate at the time of printing.
 HED, Inc. reserves the right to change specifications without notice.
 All trademarks in this material are property of HED®.
 All rights reserved HED®.

